

## KEEP BIKE SPOTLESS AND IN GOOD SHAPE FOR LONGER SPIN

### GET THE TIPS BICYCLE



### INSTRUCTIONS



1. Spray water to the bike to remove any big dirt or grimes. Then, come in with the WD-40 Specialist, Bike Cleaner, spray on bike and wipe away any dirt and grimes with clean cloth to give it a good clean.

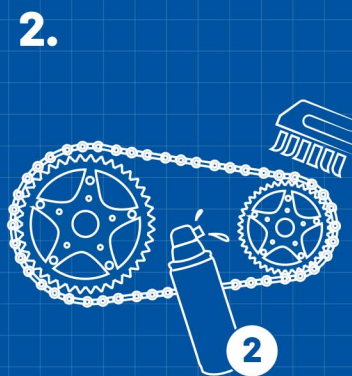

2. Don't forget to clean the chains with WD-40 Specialist, Bike Degreaser. Take a brush or a wet sponge, to clean all the heavy grime. Wash it with water and wipe with dry cloth.

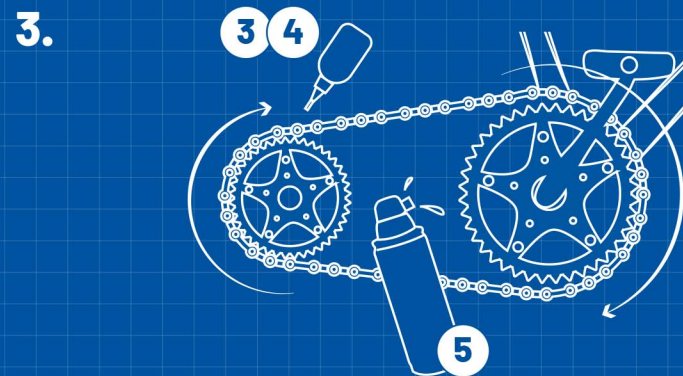

3. Take your pick from the WD-40, range of Bike Chain Lubes lubricate the chains. Rotate the pedal of your bike, to allow the chains to rotate and with the precision nozzle, spray directly on the chain lengths. Let it settle in and wipe away any residue to avoid buildup.  
*Bike lube 101:*  
WD-40 Specialist, Bike Chain Wet Lube to help waterproof chain  
WD-40 Specialist, Bike Chain Dry Lube prevents dirt from sticking  
WD-40 Specialist, Bike Chain Lube is great for high performance ride for dry and wet conditions



4. For overall polish and protection, lube up the metal parts, nuts and bolts, shifting system and pedal with WD-40. Smart Straw, to keep them in good shape for the long run.

*Tip! Lubricate chains prior to riding to avoid friction damage and extend the life of the chain.*

### WHAT YOU NEED

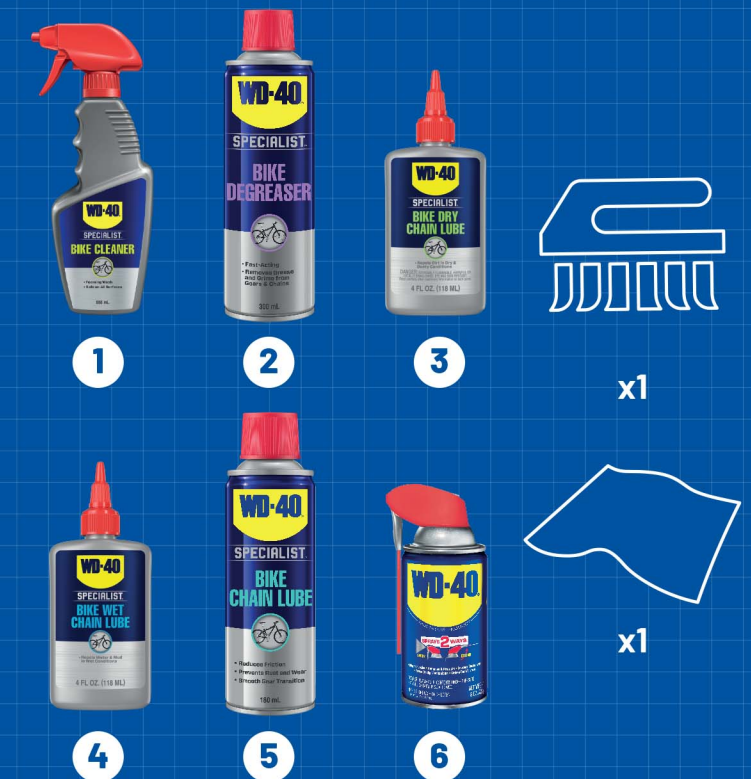

Scan For More Info



- 1 WD-40 SPECIALIST, BIKE CLEANER + 2 WD-40 SPECIALIST, BIKE DEGREASER +  
3 WD-40 SPECIALIST, BIKE CHAIN DRY LUBE + 4 WD-40 SPECIALIST, BIKE CHAIN WET LUBE +  
5 WD-40 SPECIALIST, BIKE CHAIN LUBE + 6 WD-40, SMART STRAW.